



ATELIER BONOMI

Cerniera a Libro Serie 608 (RH/LH) 608 Series Paumelle Hinge (RH/LH)

Dimensioni
Dimensions

H	W	D
190	100	18

Dimensioni in millimetri
Dimensions given in millimeters

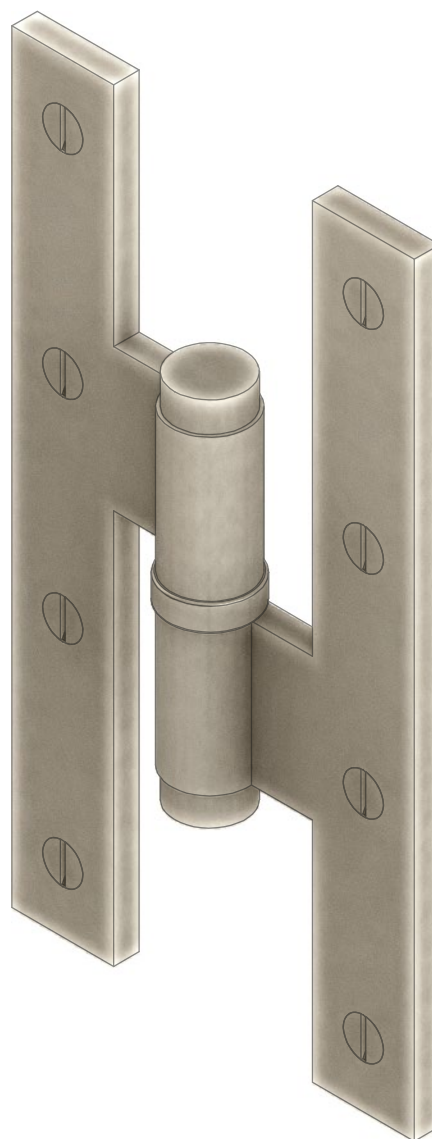
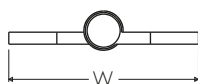
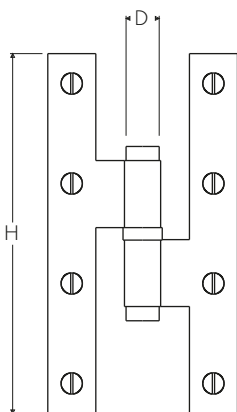

Ghiera con cuscinetti a sfera, perno in acciaio e viti legno in finitura coordinata.
Disponibile in tutte le finiture standard.

Dimensioni e finiture su misura disponibili su richiesta.

Stainless steel pin, ball bearings and wood screws in matching finish.

Additional sizes available by special order. Available in standard and custom finishes.